

General Information:

Gewicht/weight	1,1 kg
Einbaulage/ Installation position	Beliebig/ Any
max.Betriebsdruck/ maximum operating pressure	350bar
max.Druck/ max. pressure (3)	350 bar
max. Vorsteuerdruck/max. pilot pressure (1,2)	350 bar

Surface:

gal. beschichtet / electroplating coated

Hydraulic data:

Druckflüssigkeit/ Hydraulic medium	(HL, HLP) per ISO 6743-4 2015
Temperatur/ temperature range	-20 to +100 °C
Umgebungstemperatur/ environmental temperature	< +50 °C
Viskositätsbereich/ Viscosity range	2.8 - 500 mm <sup>2</sup> /s

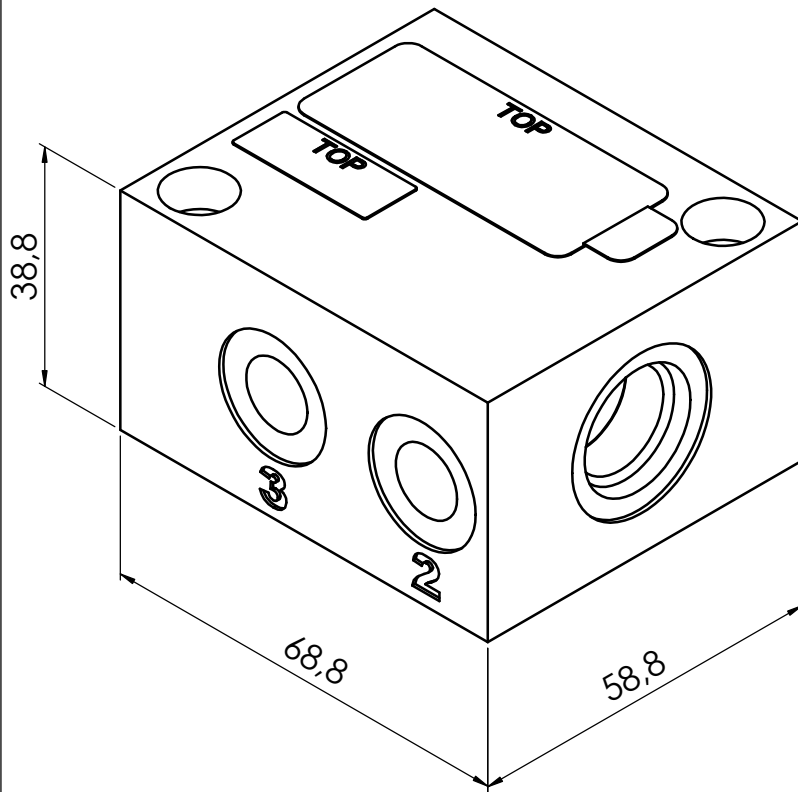

we engineer your progress

Anschluss/ port	Anschlussgröße/ size	Norm	Anzugsmoment/ torque	Erläuterung/ annotation
1	G1/4"	ISO 1179-1	Spezifikation	/
2	G1/4"	ISO 1179-1	Spezifikation	/
3	G1/4"	ISO 1179-1	Spezifikation	/

schumachers	prepared on	06.11.23	project no.	23.002.5140	identity no.	978.004.032.9	index 00	page	1	of	2
-------------	-------------	----------	-------------	-------------	--------------	---------------	----------	------	---	----	---

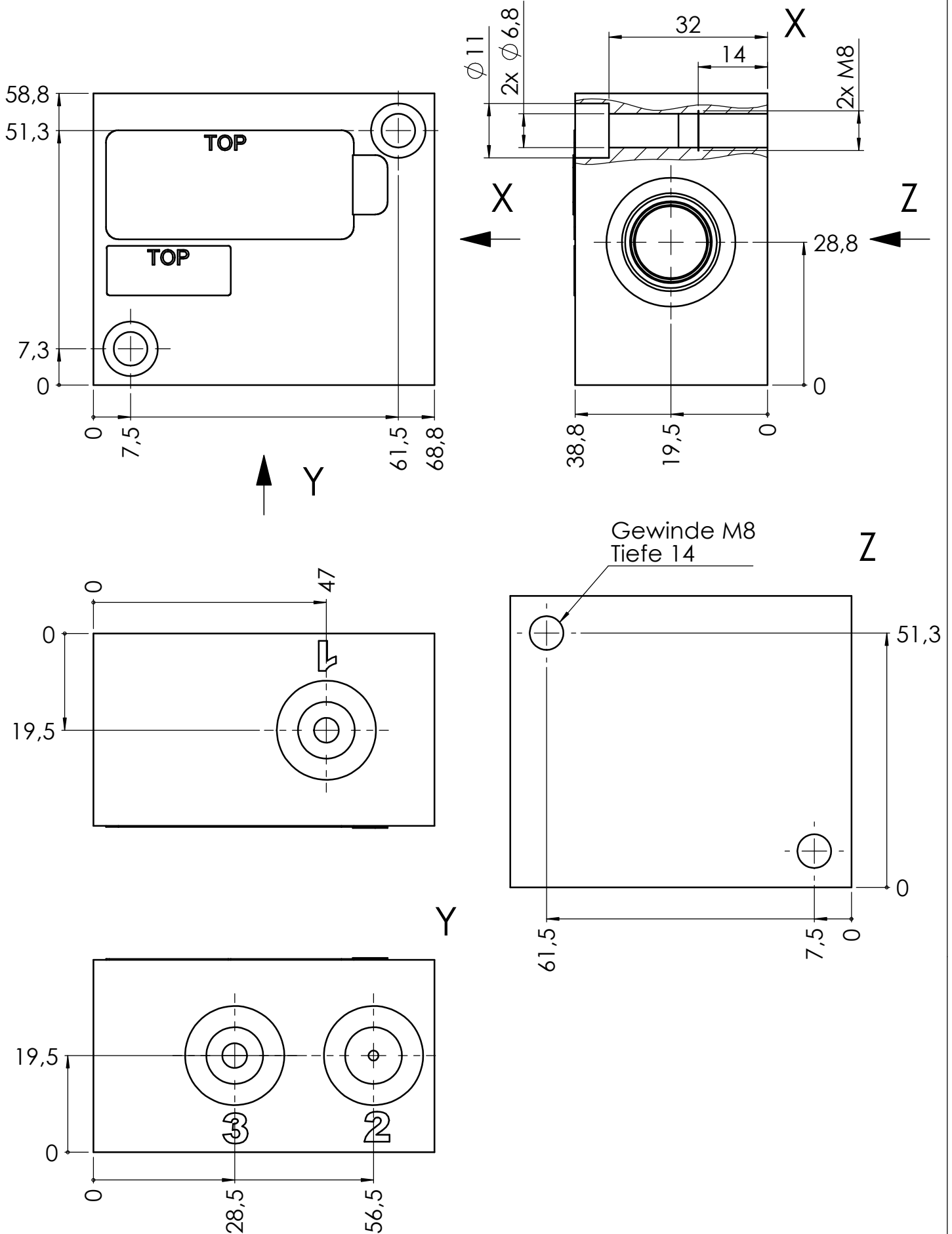

we engineer your progress